

B.D.K. ENGINEERING INDUSTRIES LIMITED



BUTTERFLY VALVE, MODEL - 12

DATE : 13 APR 2005

DRG.NO : 120014

02
REV.NO.
PN-10

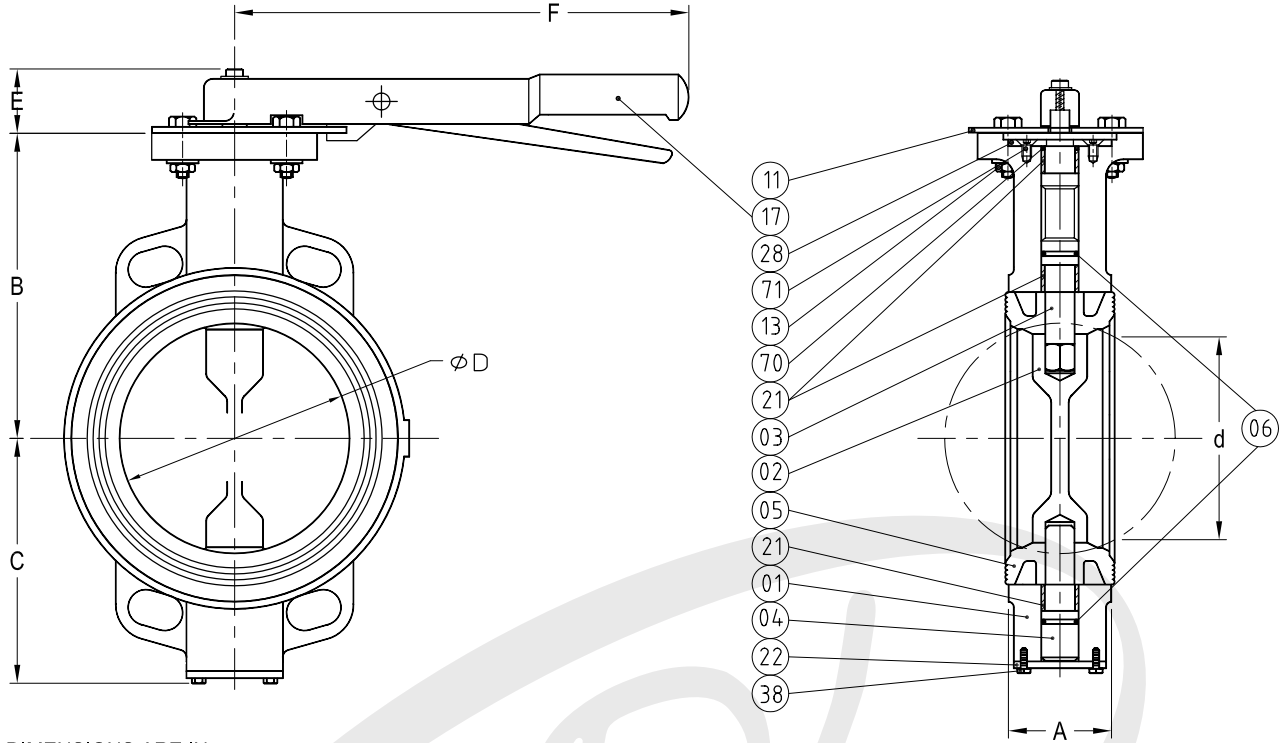

ALL DIMENSIONS ARE IN mm.

SIZE	200	250	300
A	60	68	78
B	221	250	277
C	175	210	250
φD	205	254	305
d	199	247	297
E	47	47	47
F	380	380	480
Wt-kg	23	29	40
QTY			
TAG NO			

PT.NO.	PART NAME	QTY	MATERIAL
01	BODY	01	CI/DI/WCB
02	DISC	01	DI/CA15/CF8/CF8M *
03	STEM-UPPER	01	410/304/316
04	STEM-LOWER	01	410/304/316
05	SEAT	01	ELASTOMER 5), 6)
06	O - RING	02	NITRILE
11	THROTTLING PLATE	01	M.S
13	BOLT/NUT/LOCK WSHR	02SET	STEEL Gr. 8.8
17	HANDLE UNIT	01	SGI
21	STEM BEARING	03	DELFIN
22	BOTTOM CAP	01	410
28	RETAINER PLATE	01	410
38	HEX. SCREW	02/04	STEEL Gr. 8.8
70	WEATHER SEAL	01	NITRILE
71	CSK SCREW WITH HEX. SOCKET	02	304/316

* DI/WCB FOR LINED DISC ⁷⁾
 ■ 2 Nos. FOR DN 200 ONLY

NOTES :

- LAYING LENGTH 'A' CONFORMS TO AND EN558 -1 SERIES 20 (BS:5155-1984) WAFER SHORT, ISO: 5752, API :609 -1983 LOW PRESSURE, AND MSS SP-67 W-1(1983). OTHER DIMENSIONS AND WEIGHTS ARE INDICATIVE.
- ALL BODIES, HANDLE UNIT AND DI DISC DULY PU/STOVING ENAMEL COATED AS STD.
- VALVES ARE SUITABLE TO SANDWICH BETWEEN ASME B16.5 CL-150, ASME B 16.1 CL-125, EN1092 PN 10, IS:6392 PN 10, BS:10 TABLE 'D' & 'E' FLANGES.
- INTERNAL DIAMETER OF PIPE SHOULD BE AT LEAST 3 mm MORE THAN 'd'.
- NATURAL, NEOPRENE, NITRILE, EPDM, HYPLON, BUTYL, SILICON, VITON.
- FOR SILICON & VITON SEAT AND VITON LINED DISC, VALVE PRESSURE RATING PN 6.
- DISC LINING MATERIALS : EBONITE, NITRILE, NEOPRENE, HYPLON, EPDM, BUTYL & VITON.

CODE	CI	DI	WCB	CA15	CF8	CF8M	410	304	316	MS	SGI
MATERIAL SPECN	IS:210 FG220	A536 60-40-18	A216 WCB	A217 CA15	A351 CF8	A351 CF8M	A276 410	A276 304	A276 316	IS: 2062	IS:1865 Gr.500/7

CUSTOMER _____
 ORDER NO. _____
 JOB/PROJECT _____

DESIGN STD: EN593 (BS:5155)
 TESTING STD: EN12266-1
 (BS:6755 PART-1)

HYDRO-TEST PRESSURE ,bar		
RATING	SHELL	SEAT
PN10	15	11
PN6 ⁶⁾	9	6.6

MANUFACTURED BY : M/s B.D.K. ENGINEERING INDUSTRIES LIMITED, HUBLI - 580 030 , INDIA

APPROVED :

CHECKED :

DRAWN :

FOR APPROVAL FOR RECORD