

HIGH PERFORMANCE, LUGGED, FOR HIGH TEMPERATURE SERVICE, LEAKAGE RATE : 0.01% OF RATED CAPACITY

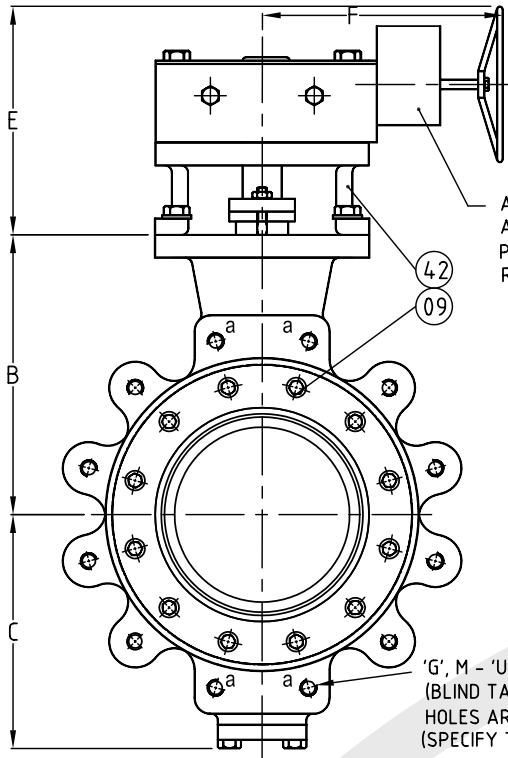

ADDITIONAL SPUR GEAR ATTACHMENT SHALL BE PROVIDED AS & WHEN REQUIRED

'G', 'M' - 'UNC - TAPPED' HOLES ON 'K' PCD (BLIND TAPPED HOLES AT 'a' WHEN THROUGH HOLES ARE NOT POSSIBLE) (See note2) (SPECIFY THREAD DETAIL)

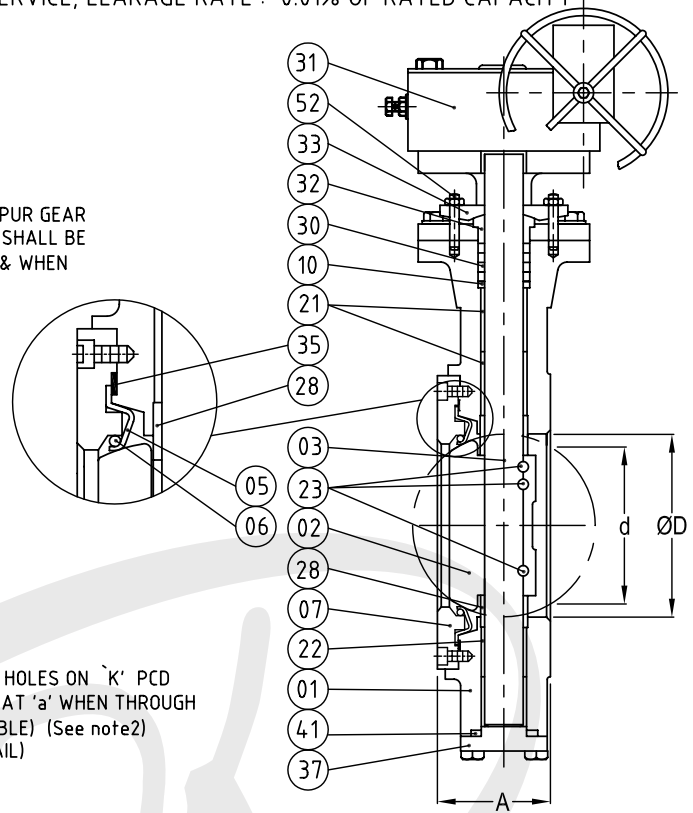

ALL DIMENSIONS ARE IN mm.

SIZE	125	150	200	250	300	350	400	450	500	600
A	59	59	73	83	93	117	133	149	159	181
B	184	200	245	280	325	360	390	430	460	540
C	162	175	210	240	285	315	355	385	420	490
ØD	134	158	214	264	314	354	399	454	494	584
d	111	135	180	220	285	302	350	396	441	526
E	326	326	359	362	523	431	431	533	595	595
F	247	247	262	311	467	491	491	520	614	742
G	8	12	12	16	16	20	20	24	24	24
M	3/4"	3/4"	7/8"	1"	1 1/8"	1 1/8"	1 1/4"	1 1/4"	1 1/4"	1 1/2"
K	235	269.9	330.2	387.4	450.8	514.4	571.5	628.6	685.8	812.8
Wt-kg	25	40	60	95	130	180	315	390	550	725
QTY										

TAG NO

NOTE :

- DIMENSION 'A' CONFORMS TO API 609. OTHER DIMENSIONS & WEIGHTS ARE INDICATIVE.
- VALVES ARE SUITABLE TO SANDWICH BETWEEN ASME B16.5 CLASS 300 FLANGES.
- INTERNAL DIAMETER OF PIPE SHOULD BE ATLEAST 3mm FOR DN125 TO DN300, 6mm FOR DN350 TO DN500, & 13mm FOR DN600 MORE THAN 'd' RESPECTIVELY.
- DISC IS HARD CHROME PLATED. STELLITING CAN BE PROVIDED ON REQUESTS.
- USE PIPE LINE FLANGE GASKET DIMENSIONS FOR SPIRAL WOUND GASKET, SHALL BE AS PER ASME B16.5 TABLE E1, FIG E2 ONLY. (NOT STD FLANGED GASKET AS MENTIONED IN API 601/ASME B 16.20). GASKET DRG AVAILABLE ON REQUEST.
- EXCEPT
  - LEAKAGE RATE CLASS IV AS PER FCI 70-2, AND TEST PRESSURE (SEAT).

CODE	WCB	CF8	CF8M	17-4PH	304	316
MATRL	A216	A351	A351	A564	A276	A276
SPECN.	WCB	CF8	CF8M	630	304	316

CUSTOMER : \_\_\_\_\_  
 ORDER NO. : \_\_\_\_\_  
 JOB/PROJECT : \_\_\_\_\_

PT. NO.	PART NAME	QTY.	MATERIAL		
01	BODY	01	WCB	CF8	CF8M
02	DISC	01	CF8	CF8M	
03	STEM	01	17-4PH		
05	METAL SEAT	01	ASTM A240 Gr.316	INCONEL	
06	SEAT BACKUP RING	01	316		
07	SEAT RETAINER	01	CF8	CF8M	
09	HEX.SOC.HD.CAP SCR	01 SET	304	316	
10	SPACER	01	304	316	
21	TOP STEM BEARING	02	NI-RESIST		
22	BOTTOM STEM BEARING	02	NI-RESIST		
23	TAPER PIN, NUT, WASHER	2/3/4 SET	304	316	
28	THRUST BEARING	02	304	316	
30	PACKING	01 SET	PRE MOULDED GRAFOIL RINGS		
31	GEAR UNIT	01	CI HOUSING		
32	GLAND	01	304	316	
33	GLAND FLANGE	01	WCB	CF8	CF8M
35	BODY SEAL	01	GRAFOIL		
37	BOTTOM COVER	01	WCB	CF8	CF8M
41	GASKET	01	GRAFOIL*/	SPW 316 GRAP. FILLED	
42	YOKE	01	WCB		
52	GLAND STUD, HEX. NUT	02 SET	304	316	

\* FOR SIZES 125 TO 200 ONLY

DESIGN STD. : API 609  
 TESTING STD. : API 598<sup>(6)</sup>  
 TEST PRESSURE, *bar*  
 HYDRO SHELL 76.  
 SEAT 04<sup>(6)</sup>

APPROVED : \_\_\_\_\_  
 CHECKED : \_\_\_\_\_  
 DRAWN : \_\_\_\_\_  
 FOR APPROVAL  FOR RECORD  FOR APPROVAL